



# Instruction Manual

---

<b>Table of Contents</b>	<b>Page</b>
• Important Safeguards	2
• Parts diagram	3
• Control Panel diagram	4
• Prior to use	4
• How to assemble	4
• How to open the Halogen Powerhead and Dome assembly	5
• How to cook (Turning On/Off)	6
• How to cook (Cooking Time set up)	6
• How to cook (Cooking Temperature set up)	7
• How to cook (Express function set up)	8
• Timer set up	8
• How to pause cooking	9
• Keep warm feature	9
• How to care and clean	10
• Helpful tips	10

**IMPORTANT SAFEGUARDS**

When using electrical appliances, basic safety precautions should always be followed, including the following:

1. All users of this appliance must read and understand this Instruction Manual before operating or cleaning this appliance.
2. To protect against fire, electric shock, do not place cord, plugs or the Halogen Powerhead in water or other liquid.
3. If the Halogen Powerhead falls or accidentally becomes immersed in water, never reach into the water to retrieve it, but unplug right away! Do not use the Halogen Powerhead after it has been immersed in water.
4. Never place appliance on or near a hot gas or electric burner, or inside a heated oven.
5. Never place electric parts on or close to flammables or combustibles. It may cause fire or explosion.
6. The cord to this appliance should be plugged into a 120V AC electrical outlet only. When removing from outlet always grab by the plug, not be pulling on the cord.
7. Do not attempt to modify the plug in any way.
8. Do not operate any appliance with a damaged cord or plug or after the appliance malfunctions, or has been damaged in any manner.
9. Do not let cord touch hot surfaces or hang over edge of table/counter.
10. Do not use an extension cord with this appliance.
11. Use this appliance only for its intended use.
12. Do not use outdoors. This appliance is designed for household use only.
13. Do not disassemble the Halogen Powerhead.
14. Using accessories or attachments not recommended by the appliance manufacturer may result in fire, electric shock or personal injury.
15. This appliance should not be left unattended while in use.
16. Close supervision is needed when this appliance is used by or near children.
17. To disconnect the Halogen Powerhead from outlet, first turn unit off by pressing the ON/OFF button.
18. Disconnect the Halogen Powerhead from outlet when not in use and before cleaning. Allow cooling before putting on or taking off parts, and before cleaning the appliance.
19. Save this Instruction Manual for future reference.

**Parts Diagram**

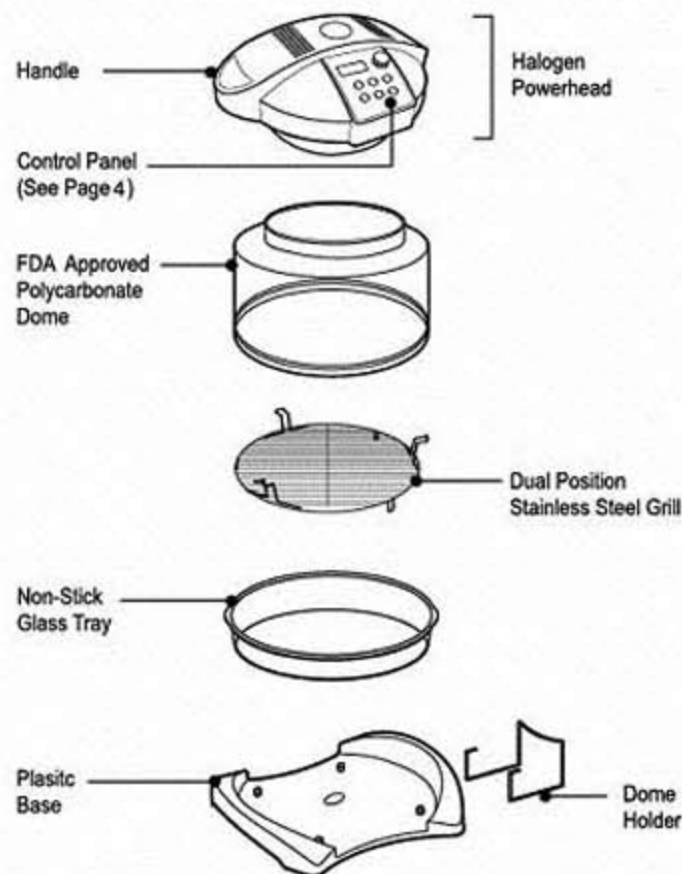

### Control Panel Diagram

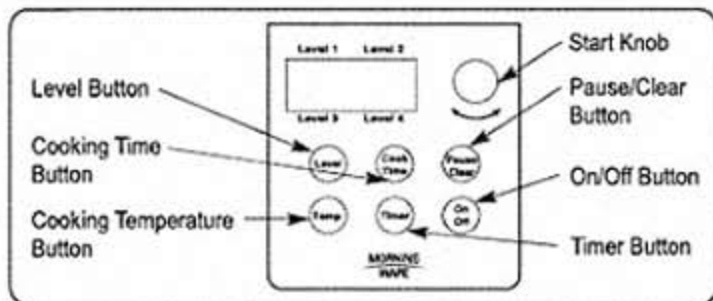

### Prior To Use

- Prior to use, clean transparent dome, stainless steel wire grill, glass tray and plastic base in your dishwasher or hot soapy water.
- **IMPORTANT: NEVER WASH OR IMMERSE THE HALOGEN POWERHEAD IN WATER OR IN DISHWASHER.** The outer portion of the Halogen Powerhead can be cleaned by wiping with a damp cloth or sponge.
- Temperature is regulated by a micro chip. When the temperature reaches the programmed temperature, the heater pauses which may cause the light to turn off. It is normal for the light to turn on and off while it is cooking.

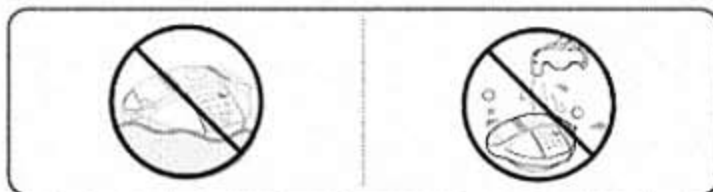

### How to assemble

- Place base on a firm and level surface.
- Place glass tray snug inside base.
- Place dual height stainless steel grill on the glass tray. Place food on the grill.
- Place dome onto the glass tray. Dome should fit evenly into glass tray.

- Place Halogen Powerhead on top and into dome. Lock it into place by rotating the Halogen Powerhead clockwise until locking lugs are engaged.
- To cook, set time and temperature according to cooking requirements.
- If you want to increase cooking capacity, place extender ring (optional part) onto the glass tray and put dome onto the extender ring.

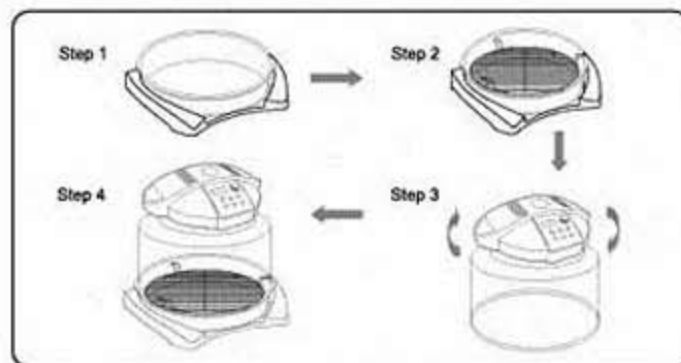

### How to open the Halogen Powerhead and Dome Assembly

- Place dome holder under one of the two base handles. Both feet of the dome holder needs to be placed inside the base handle so the dome holder rests horizontally on a flat surface as shown in step 1.
- When the Halogen Powerhead is tightly locked into the dome, the Halogen Powerhead and dome can be easily opened and placed on the dome holder as shown in steps 2 and 3.



**WARNING**

1. Never touch the hood, dome, glass tray or any surfaces on the Halogen Powerhead while cooking is in process. During operation, the air inside the dome gets extremely hot and it makes the surface very hot and may cause burns. Be extremely careful and use oven mitts when removing the glass tray from a base while it is still hot.
2. All items in the Halogen Oven, such as the stainless steel grill and glass tray can get very hot during cooking. Please be extra cautious when removing these items from a hot oven. Always use oven mitts or pot holders.
3. The dome opening may expand slightly when hot. In rare instances, the Halogen Powerhead could detach itself from the dome thereby causing hot air to escape from between the dome and the Halogen Powerhead.

**How to cook**

Once the Halogen Powerhead and dome are locked in place, the Halogen Powerhead handles allow you to lift them all together when removing or checking on food. Always make sure to grip both handles when lifting. For best cooking results, follow the time, temperature, and rack height instructions in the recipe book. Remember that No Preheating is ever required.

**A. Turning On/Off**

- After plugging the Halogen Oven in 120V outlet, start by pressing the "ON/OFF" button.
- The display will show the default "0" setting.
- The Halogen Oven does not emit any heat or light at this setting.

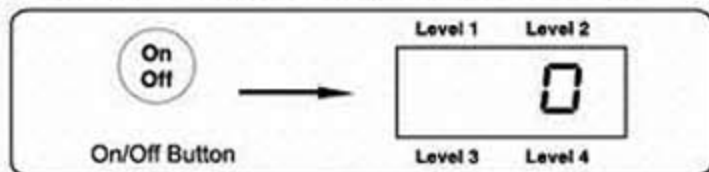

**B. Cooking Time Set Up**

- Press the "COOK TIME" button.
- The display will show the default "0:00" setting. The minute "00" will be flashing.

- To set the minutes, rotate the "START" knob to the right or left.
- To program the cooking hours, push the "COOK TIME" button. The hour "0" will begin to flash.
- To set the hours, rotate the "START" knob to the right or left.
- If you want to change cooking time, press the "COOK TIME" button once more to reset cooking minutes and hours.
- After the cooking time is set up properly, push in the "START" knob.
- The Halogen Oven will "beep" when cooking is complete.
- Unless a user sets a specific cooking temperature, the Halogen Oven automatically cooks food at the highest temperature of 400°F.

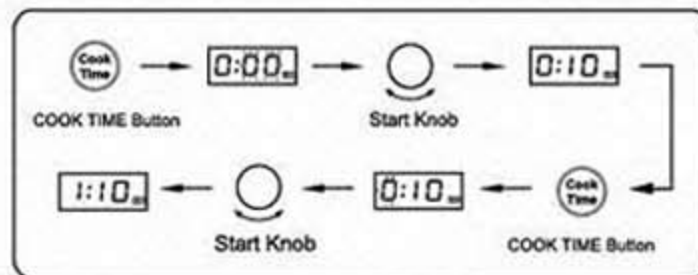

**C. Cooking Temperature Set Up**

- Once cooking time is set up, press the "TEMP" button.
- The display will start flashing the default temperature setting of "400".
- To set the temperature, rotate the "START" knob to the left or right.
- The lowest temperature setting is 190°F and the highest temperature setting is 400°F. Temperature will increase/decrease by 15° when rotating the "START" knob.
- Push in "START" knob to start cooking.
- The Halogen Oven will "beep" when cooking is complete.

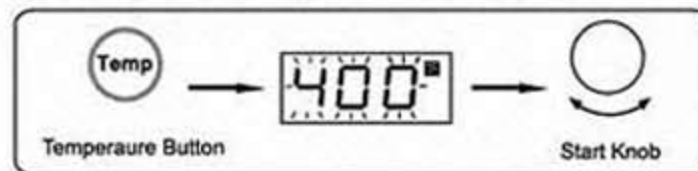

#### D. Express Function Set Up (Level)

This automatically sets the Halogen Oven at the highest cooking temperature (400°F). Level 1 cooks for 1 hour, Level 2 for 45 minutes, Level 3 for 30 minutes and Level 4 for 15 minutes.

- Press the "LEVEL" button.
- The display will show the default "0" setting.
- When pressing the "LEVEL" button the power level changes from Level 1 -> Level 2 -> Level 3 -> Level 4.
- Verify that the correct "LEVEL" setting is shown in the display.
- Push in the "START" knob.
- If the "LEVEL" setting needs to be changed after the Halogen Oven starts, press the "PAUSE/CLEAR" button once and re-enter the correct "LEVEL".
- The Halogen Oven will "beep" when cooking is complete.

To pause cooking, press the "PAUSE/CLEAR" button once. The display will show the remaining cooking time. The display will show the remaining cooking time.

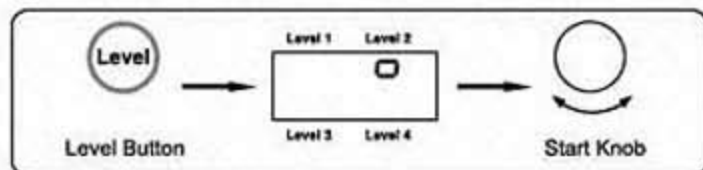

#### Timer Set Up

- Once the cooking time and temperature is set up, press the "TIMER" button.
- The display will show the default "0:00" setting. The minute "00" will be flashing.
- To set the minutes, rotate the "START" knob to the right or left.
- Press the "TIMER" button again to program the hours. The hour "0" will begin to flash.
- To set the hour, rotate the "START" knob to the right or left.
- Pressing the "TIMER" button once more sets the timer.
- After the timer is properly set, push in the "START" knob to engage the count down.
- Delay time is limited up to "1:59" (one hour, 59 minutes).
- Cooking is finished when the display timer shows zero.
- When you use "Timer Set Up" for the "Express Function", the process is the same as above.

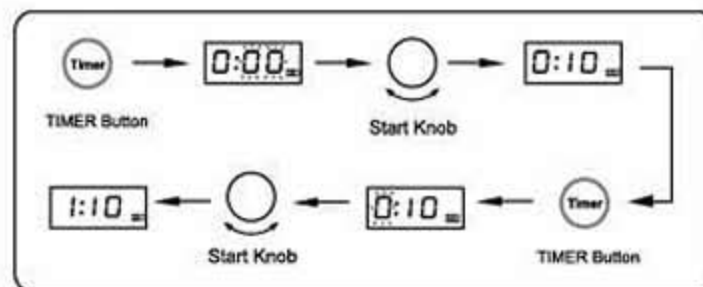

#### Example for timer set up:

- Set up Cook Time and Temperature at 1:40 at 400°F.
- Press "TIMER" button.
- Set up Timer Hour & Minute as 1:10.
- Push in Start knob to start cooking.
- Display shows "2:50" (= 1:40 + 1:10).
- Machine starts cooking 1:10 after setting up and cooks food for 1:40 at 400°F.

#### WARNING

Regards to Timer Set Up, our recommendation is not to delay cooking for more than 1 hour for all foods except raw vegetables. If you have further questions, please refer to the following website at <http://www.foodsafety.gov> (United States Department of Agriculture).

#### How to pause Cooking

To pause cooking, press the "PAUSE/CLEAR" button once. The display will show the remaining cooking time. To restart cooking, push in the "START" knob.

#### Keep Warm Feature

When the cooking time expires, the temperature automatically decreases to 190°F to keep the food warm for up to 3 hours. Pressing the Clear/Pause or On/Off button will stop Keep-Warm feature. To keep the food from drying out cover it with aluminum foil.

### How to care and clean

1. Before cleaning unplug the unit.
2. Allow the unit to cool down before cleaning. Do not attempt to wash the glass tray until it cools to room temperature. Pouring cold water on the glass tray while hot could cause the glass to crack and/or break.
3. All the parts, EXCEPT the Halogen Powerhead are dishwasher safe.
4. To protect the metal and plastic surfaces do not use abrasive cleaners or scouring pads.
5. A damp cloth or sponge can be used to clean the outer surface of the Halogen Powerhead. Do not disassemble the Halogen Powerhead to clean the inside of the heating chamber.

### Helpful tips

1. For proper operation always check the power source. Do not operate the unit with other major appliances in the same power outlet. If the unit cooks too slowly check that the Temperature or Power Level is set up properly.
2. Moisture may build up inside the dome when cooked food is not removed soon after cooking time has expired. Removing food soon after it is done cooking can avoid the steam/moisture build-up.
3. The Halogen Oven will "beep" when cooking is complete.
  - a. Maximum cooking time for Temperature 385°F-400°F: 3:00.
  - b. Maximum cooking time for Temperature below 385°F: 9:59.
  - c. Maximum Delay time regardless of Temperature: 1:59
4. Placing the glass tray directly onto a stove burner or direct heat source may cause it to crack/break.
5. The use of metal and glass dishes, pans, and foil is safe within the Halogen Oven. Do not use paper, flammables or plastics within the Halogen Oven.